

LAND FOR SALE

## 9 +/- ACRES OF PRIME INVESTMENT OR RESIDENTIAL OPPORTUNITY NEAR BIG CEDAR AND THUNDER RIDGE

PRICE: **\$77,000**  
COUNTY: **STONE**  
STATE: **MISSOURI**  
ACRES: **9**



### PROPERTY FEATURES

- 15 minutes west of Long Creek Marina, Thunder Ridge, Big Cedar
- Approximate 1-acre level build site
- No covenants or restrictions
- Shared well and power access at the road
- Annual dues \$165
- Close to the lake
- On a dead-end road
- Affordable
- Priced to sell
- Potential views

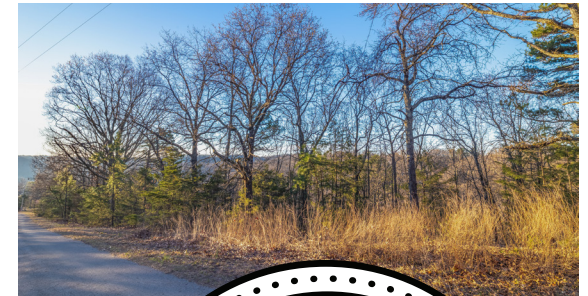

For more information, contact:

**BJORN WILKERSON**, Land Agent

**417.233.1243** | [BWilkerson@MidwestLandGroup.com](mailto:BWilkerson@MidwestLandGroup.com)

**MidwestLandGroup.com**

